

WYE CONNECTOR SERIES

SINGLE POLE POWER DERIVATION

Technical Characteristics

Electrical

- Nominal current : 400 A max. with 120 mm² cable
- Clearance and creepage distance : EN 50124
- Service Voltage (EN 50124) :
 - 750 V : OV2-PD4
 - 1500 V : OV2-PD3
 - 3000 V : OV2-PD2
- Test voltage : 5750 V
- Insulation Strength : > 5000 MΩ

Material

- Shell : composite
- Insert CTI : 600 V, UL94V0, without halogen, according to fire & smoke requirements (EN 45545-2, NF F 16-101 / 16-102)
- Crimp Contacts : copper or brass silver plated

Environmental

- Temperature range: -40°C +100°C
- Protection index : IP66 (EN 60529)
- Salt spray : 96 hours

Mechanical

- Contacts Cross-Sections : from 35 to 120 mm²
- Mating cycles : 500
- Vibrations & Shocks : Category 2 (EN 61373)
- Locking by captive screws
- Keying system : 6 keyways

Possible Configurations

Single Connector

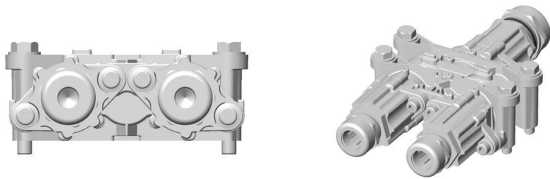

2 connectors fixed on a plate

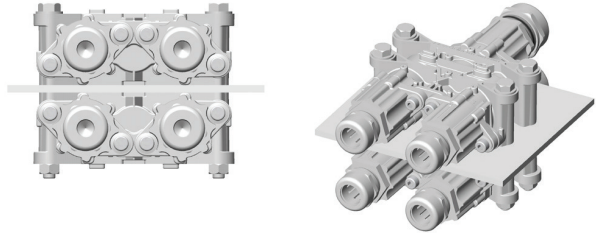

2 stacked connectors

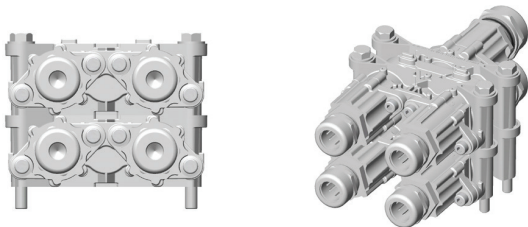

2 stacked connectors in reversed position

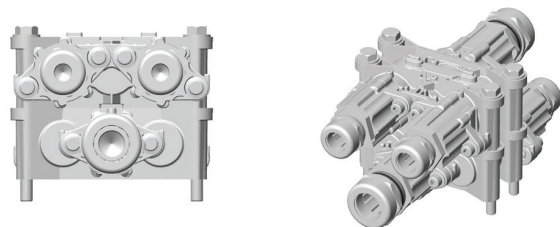

Dimensions - mm (inch)

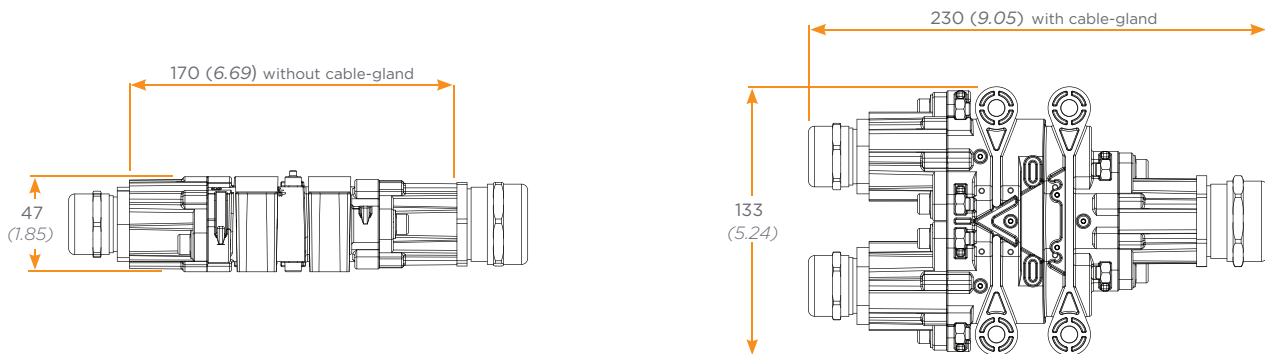

Part Numbers

Description		Part Number
Plug without cable-gland	35 mm ²	WYE1817-0007-00000
	50 mm ²	WYE1817-0006-00000
	70 mm ²	WYE1817-0005-00000
	95 mm ²	WYE1817-0004-00000
	120 mm ²	WYE1817-0003-00000
Receptade		WYE1817-0001-00000

te.com/rail

© 2017 TE Connectivity Ltd. family of companies. All Rights Reserved. TE Connectivity, TE connectivity (logo) and Every Connection Counts are trademarks. 1-1773909-7

While TE has made every reasonable effort to ensure the accuracy of the information in this brochure, TE does not guarantee that it is error-free, nor does TE make any other representation, warranty or guarantee that the information is accurate, correct, reliable or current. TE reserves the right to make any adjustments to the information contained herein at any time without notice. TE expressly disclaims all implied warranties regarding the information contained herein, including, but not limited to, any implied warranties of merchantability or fitness for a particular purpose. The dimensions in this catalog are for reference purposes only and are subject to change without notice. Specifications are subject to change without notice. Consult TE for the latest dimensions and design specifications